

V-TEK™ Handles - Four different styles of handle are available for manual actuation of Butterfly Valves:

**TYPE - VG12 - PVC**

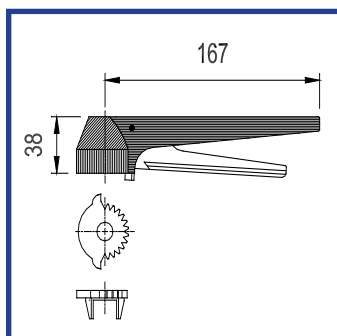

**V-TEK™ BUTTERFLY VALVE**

**- PVC LEVER HANDLE & NOTCH PLATE**

- MULTI-POSITION HANDLE (12 Position).
- NYLON 6+GLASS FIBRE REINFORCED
- LOCKABLE HANDLE AVAILABLE.
- GRIPPER BAR IS SPRING LOADED TO LOCK SECURELY IN NOTCH PLATE TEETH.

**TYPE - VG12 - ST/ST**

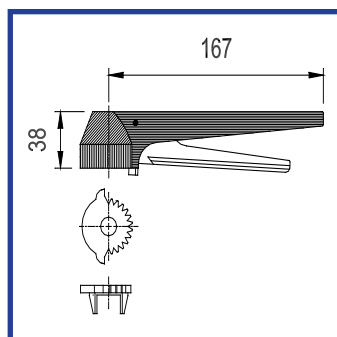

**V-TEK™ BUTTERFLY VALVE**

**- LEVER HANDLE & NOTCH PLATE IN STAINLESS STEEL**

- SS304 HANDLE (12 Position).
- STAINLESS STEEL GRIPPER
- LOCKABLE HANDLE AVAILABLE.
- GRIPPER BAR IS SPRING LOADED TO LOCK SECURELY IN NOTCH PLATE TEETH.

**TYPE - VG12 - PVC**

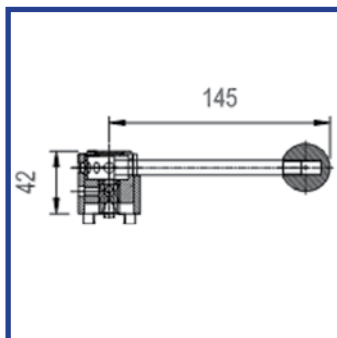

**V-TEK™ BUTTERFLY VALVE**

**-VP4 STAINLESS STEEL PULL HANDLE 304**

- SS304 HANDLE WITH PHENOLIC BALL END
- MACHINED AND POLISHED FOR SANITARY USE
- 4 LOCKING POSITIONS.
- HANDLE SHAFT IS SPRING LOADED TO LOCK SECURELY IN PLACE.

**TYPE - SUREGRIP VG12**

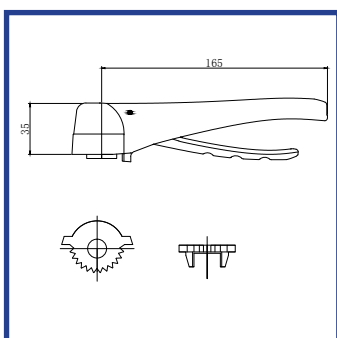

**V-TEK™ BUTTERFLY VALVE**

**-SUREGRIP VG12 & NOTCH PLATE**

- MULTI-POSITION HANDLE (12 Position).
- NYLON 6+GLASS FIBRE REINFORCED
- LOCKABLE HANDLE AVAILABLE.
- GRIPPER BAR IS SPRING LOADED TO LOCK SECURELY IN NOTCH PLATE TEETH.